

# MF 86 *XSafe*

## Modular Ice Machine 2400 kg

Item #:
Project:
Quantity:



### FEATURES

- Semi-hermetic compressor. Stainless steel auger and freezing cylinder (evaporator). Equipped with an electromechanical control panel.
- Ice breaker made in specially strengthened alloy, allowing for greater extrusion pressure to deliver a dryer-quality of ice (85% dry).
- Long-lasting stainless steel ball-bearings. Current protection on gear motor and safety coupling between gear box and auger.
- Low-water pressure switch. Ice level thermostat for machine shut down.
- Stainless steel side panels in scotch-brite finish, with rounded corners for enhanced ease of cleaning and aesthetics.
- Side panels are removable on all four sides to ease maintenance and after-sales service operations.
- Top cover in PS. Ice chute with extension.
- Reduced height to ease installation.
- XSafe: natural sanitation system, integrated inside the ice maker and operating automatically 24/7 to keep equipment clean & safe.



MF 86  
Superflake ice  
Residual water content 15%

### CONDENSING SYSTEM

Air cooled  
Remote condenser  
Water cooled

### REFRIGERANT GAS

R452A

### VOLTAGE V/Hz/ph

230/50/3  
230/60/3  
380/60/3N  
400/50/3N

### RECOMMENDED BINS

Head	Bins		kg
MF 86	●	<b>UBH2250</b>	1068
	●	<b>SIS1350</b>	613 + 73 + 73

#### LEGEND:

- ✓ : Perfect combination between ice maker and bin
- : Ice chute cut-out performed upon installation
- CBTxxxxxxxx : need additional bin top

### CERTIFICATIONS



### OPERATING REQUIREMENTS

	Minimum	Maximum
Air temperature	10	43
Water temperature	5	38
Water pressure	1 bar (14 psi)	5 bar (70 psi)
Electrical voltage	-10%	+10%

**IMPORTANT NOTICE:**  
Models and specifications are subject to change without notice.  
This spec sheet is meant for commercial purpose only.  
For technical documentation please refer to our service manuals.

[www.scotsman-ice.it](http://www.scotsman-ice.it)  
[www.scotsman-ice.com](http://www.scotsman-ice.com)

Modular Ice Machine 2400 kg

# MF 86 *XSafe*

## Modular Ice Machine 2400 kg

Item #:
Project:
Quantity:

Modular Ice Machine 2400 kg

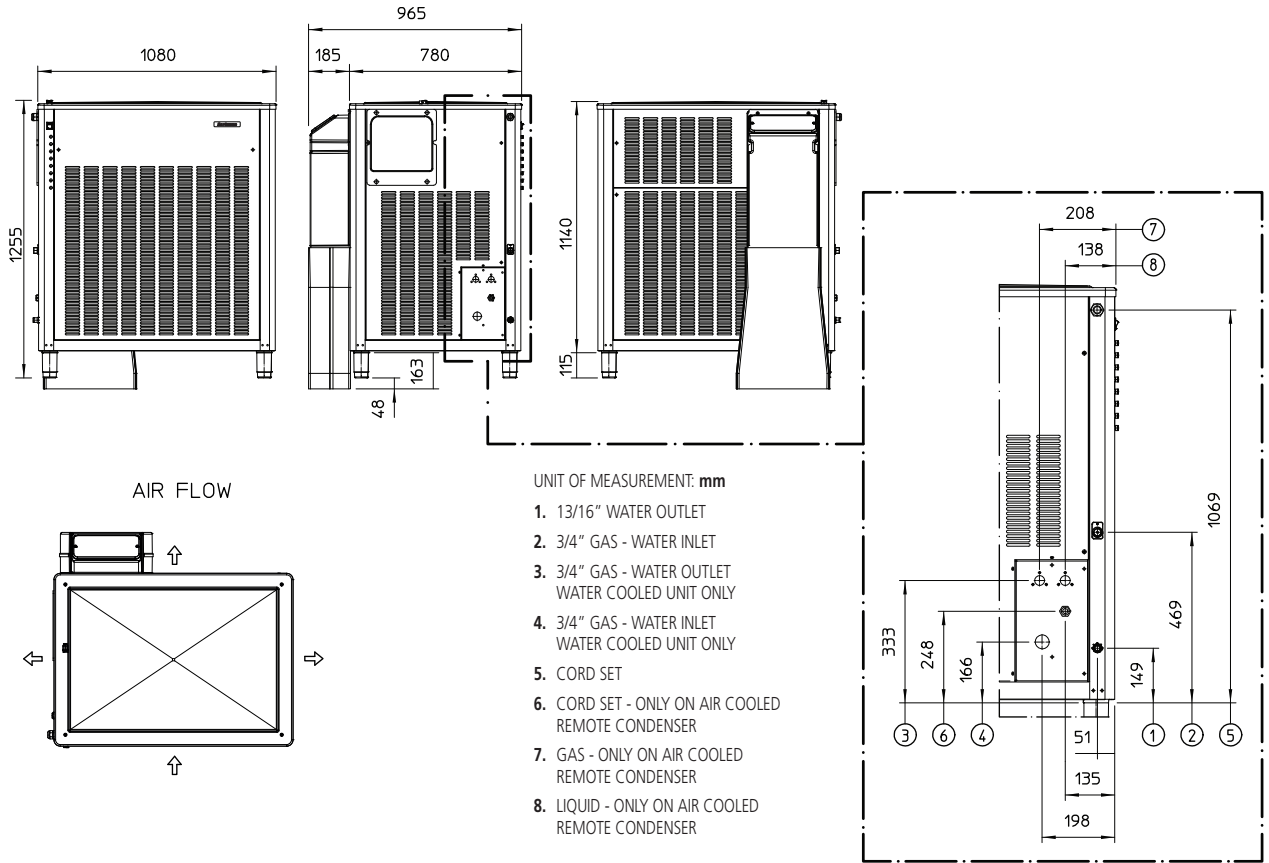

UNIT DATA		SHIPPING DATA	
Size (W x D x H)	1080 x 965 x 1255 mm	Carton (W x D x H)	1170 x 920 x 1340 mm
Net weight	362 kg	Weight	383 kg

Version	Voltage	24 h ice production kg °C Amb. / °C Water			Energy consumption (*)		Water usage (*)	Instant power	Compressor	Circuit wires	Max. fuse size
		10°C/10°C kg	21°C/10°C kg	32°C/21°C kg	kWh/ 100 kg	kWh/ 24h	l/h	W	W	No. x Ømm²	A
MF 86 AS	230/50/3	2400	2200	1700	7.4	138.5	77.1	6100	10000	4 x 4.0	32
MF 86 AS	400/50/3N	2400	2200	1700	7.4	138.5	77.1	6100	10000	5 x 4.0	25
MF 86 WS	400/50/3N	2400	2200	1700	7.4	138.5	416.7	5800	10000	5 x 4.0	32
MF 86 AS	230/60/3	2400	2200	1700	8.1	149.6	77.1	6280	6730	4 x 6.0	32
MF 86 AS	380/60/3N	2400	2200	1700	8.1	149.6	77.1	6280	6730	5 x 4.0	25
MF 86 ASR	380/60/3N	2400	2200	1700	8.1	149.6	77.1	6280	6730	5 x 6.0	32

(\*) Data refer to 32°C Amb. / 21°C Water temperature conditions